

UNLOCK IT!

BY YMCA OF THE NORTH



Bryant Lake Regional Park, 6800 Rowland Road, Eden Prairie

Unlock It! is a fun adventure challenge for all ages. Using your feet, problem-solving ability and teamwork, follow the clues to reveal a set of letters. Once you have all the letters, unscramble them to form the keyword that solves this Unlock It!

Key



Restrooms



Parking



Stairs

Distance: 2 miles

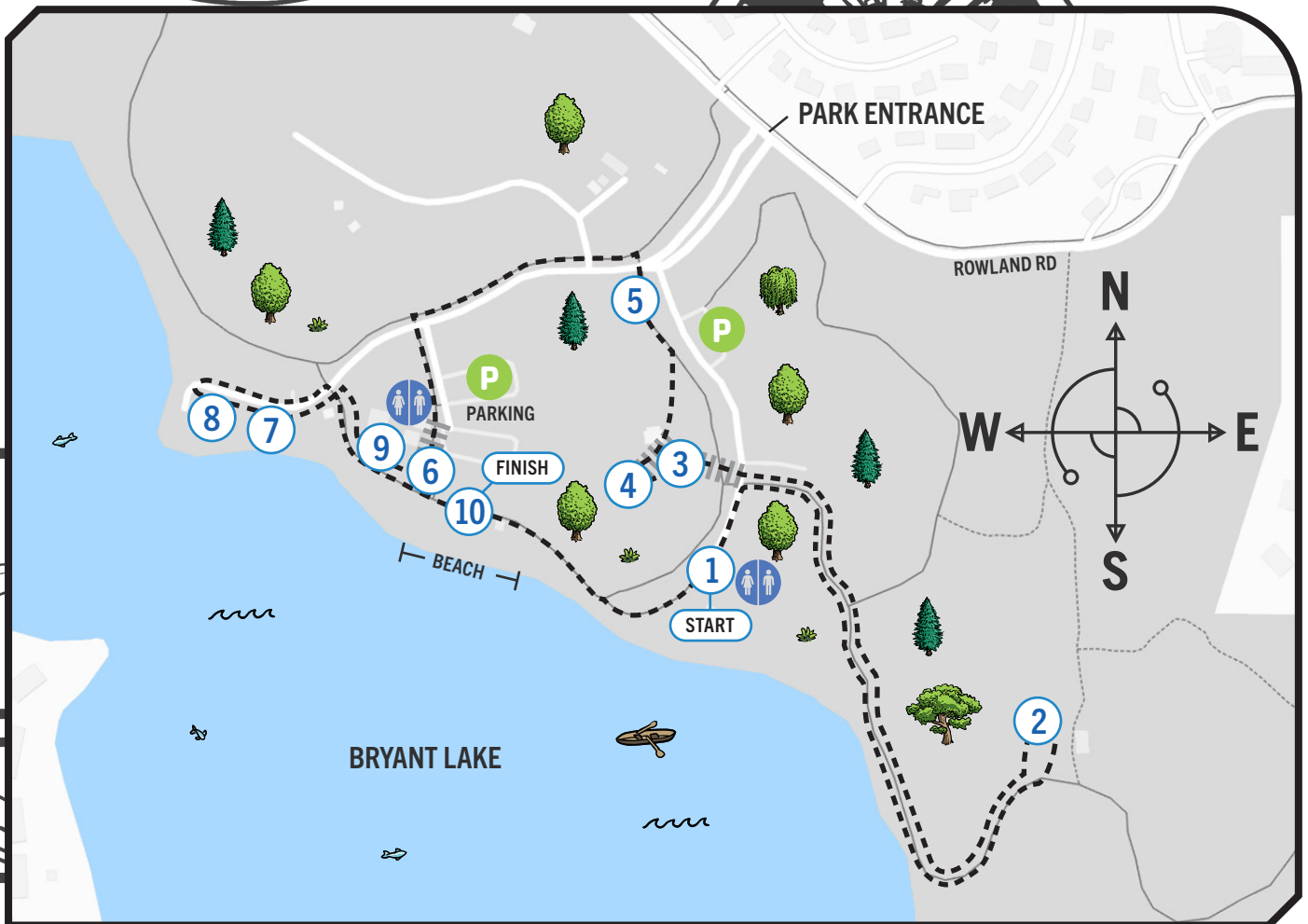

PRESENTED BY



ENVIRONMENT
AND NATURAL RESOURCES
TRUST FUND

The answers to the clues below reveal key letters needed to solve your *Unlock It!* adventure.

CLUE

Starting at the beach and looking at the lake, take the paved path south past the boathouse. When a trail option is paved or unpaved, choose the unpaved one closest to the lake until you reach a picnic area with a bathroom building. What is this area of the park called? Use the first letter of the second word.

1

_____ _____

CLUE

Continue past the bathroom building until you meet the paved road. Walk north until you see a paved path to the right. Take this path in the direction that keeps the lake on your right. Cross a bridge and keep going until you reach a large shed on your left side. What material is the roof made of?

2

_____ _____

CLUE

Retrace your steps, this time staying on the blacktop trail until you cross a road; when the trail comes to a T, go right and watch for a feature of this park guaranteed to take your breath away when you climb it. Do so while counting the exact number of risers to the top. Have each member of your group count separately to make sure you get an exact count. Subtract 112 from your total. What letter is that number in the alphabet? It reveals one of your letters.

3

BONUS: This is the first letter of your keyword.

CLUE

Take the gravel trail on a downward slope looking for a large (very large!) solid geological formation. Sit or stand high on it and use the first letter of this word.

4

CLUE

Now head North on the gravel path, and look around for signs of a game. What is the game? Use the first letter of the second word.

5

_____ _____

CLUE

Back at the beach, go north until the paved trail forms a new letter. What is it?

6

BONUS: This is the last letter of your keyword.

CLUE

Take the trail closest to the lake toward the boat landing. Louise wants you to "sit awhile and enjoy..."

7

U R E ' S B E A U T Y

CLUE

Nearby, three words are used to describe Chase. Write the three words below. What is the second letter in two of the three words?

8

CLUE

Go to the play area and slide down the highest slide. How many stories up is it? Use the first letter in that word.

9

CLUE

Go the main beach and count the number of umbrella stands plus the number of volleyball courts (there will be no nets in the off-season). That's how many letters are in your keyword.

10

Carry down the letters from the clues above into the placeholders below.

Now complete your *Unlock It!* adventure by unscrambling the letters into your keyword.

Hint: the keyword is a character trait that reveals honesty.

Congratulations!



Use the QR code to submit the keyword for a chance to win fun prizes. Or visit the website below.

ymcanorth.org/unlock-it-keyword